

UNDERCUT ANCHORS

Undercut anchor for pre-positioned (FZA bolt version and internally-threaded anchor FZA-I) and push-through installation (FZA-D bolt version).  
A cylindrical conical hole with an undercut is produced with the drill bit FZUB in one work process.  
When setting the anchor, the anchor sleeve is driven over the cone with a hammer (or setting tool) and fills the undercut hole with a positive fit.  
Also available: special version FZA ST A4 for hot step irons according to DIN V 1211 GS / 1212 GS.  
Stainless steel version of the corrosion resistance class III e.g. A4 for outdoor use and in damp conditions. *resistance clas IV e.g. 1.4529 for applications in aggressive atmospheres*  
Highly corrosion-resistant steel of the corrosion

code	description	drill	anc/dep	max use	thread	box qty
FZA10X40	Zykon undercut anchor	10mm	40mm	10mm	6mm	100
FZA12X40	Zykon undercut anchor	12mm	40mm	15mm	8mm	100
FZA12X50	Zykon undercut anchor	12mm	50mm	15mm	8mm	100
FZA14X40	Zykon undercut anchor	14mm	40mm	25mm	10mm	100
FZA14X60	Zykon undercut anchor	14mm	60mm	25mm	10mm	100
FZA18X80	Zykon undercut anchor	18mm	80mm	25mm	12mm	100
FZA22X100	Zykon undercut anchor	22mm	100mm	60mm	16mm	100
FZA22X125	Zykon undercut anchor	22mm	125mm	60mm	16mm	100

Approved for:

Cracked and non-cracked concrete B25 to B55 resp. C20/25 to C50/60

Also suitable for:

Concrete B15 resp. C12/15  
Natural stone with dense structure  
Solid brick  
Solid sand-lime brick

For fixing of:

Steel constructions  
Railings  
Consoles  
Ladders  
Cable trays  
Machines  
Staircases  
Gates  
Facades  
Window elements



Advantages/benefits

Positive fit in the undercut gives additional safety.  
Virtually expansion-free operation allows cost-efficient fixing with very small edge distances and axial spacings.  
Single-step drilling process simultaneously produces the undercut, saving installation time.  
Immediate load-bearing capability avoids installation interruptions (no interruption for resin curing times, unlike chemical anchors).  
Simple visual control of the green ring mark ensures 100% function.  
Anchor version with internal thread for high flexibility by using threaded rods or screws of different lengths and type.

MULTI BOLT FMB

code	description	drill	anchor	thread	depth hole
FMB20/20	Multi use bolt fmb	20mm	138mm	16mm	100mm

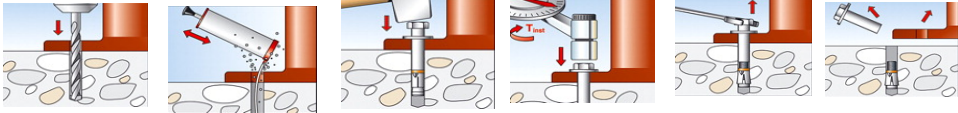

Usage

Suitable for:

Concrete = C12/15  
Natural stone with dense structure

For fixing of:

Bracings of formwork  
Precast concrete tilt up panels

Advantages/benefits

Economical system, as the anchor screw can be re-used 5 to 10 times.  
20 mm steel diameter of the anchor screw for higher shear forces.  
Expansion component with fischer know-how for optimised grip.  
No projecting anchor parts after the removal of the anchor screw. This means high level of safety on site and time  
Typical hexagon nut which is also used for other applications, thereby no change of tool is necessary.  
Large washer for better load distribution.