

Spit Satelis

Hollow Material Fixing System



Chemical Resin

Gives high loads in hollow base materials.



Use with Epomax and C Mix Plus

Product Range - Eurocodes & Descriptions

Eurocode	Description	Thread Ø	Stud Length	Drill Ø	Fixture Thickness	Box Qty
062340	M6 x 58 Socket	6mm	n / a	20mm	n / a	10
062300	M8 x 80 Stud	8mm	80mm	20mm	10mm	10
062350	M8 x 58 Socket	8mm	n / a	20mm	n / a	10
062310	M10 x 90 Stud	10mm	90mm	20mm	18mm	10
062360	M10 x 58 Socket	10mm	n / a	20mm	n / a	10
062320	M12 x 90 Stud	12mm	100mm	20mm	25mm	10

Technical Specification

Satelis spring loaded action of the assembly ensures contact with the substrate. Inject the resin and install the socket or stud assembly.

Polypropylene body, polyacetal spring and high density polyethylene flange assembly, resin retainer, zinc plated metal studs (steel S300Pb, zinc coating NFA35561), Zinc plated metal sockets (steel S300Pb, zinc coating NFA35561), nut grade 6 (NFE 25400-0, zinc coated), washer E24 zinc coated NFE 25513111.

Substrates

- Hollow block
- Hollow slab
- Plasterboard

Applications

- Signs
- Electrical switchboards
- Radiators
- Hand rails

Product Advantages

- High performance system for fastening to the front face of hollow base materials
- Creates large bearing surface to achieve high loads
- Reinforces spalled area in thin section masonry
- Choice of projecting stud or internally threaded socket
- Self adjusts to wall thickness
- Eliminates the need for timber inserts in some applications

Installation

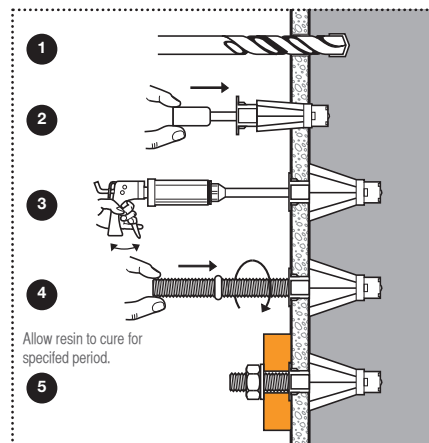

For details of threaded studs and accessories, see pages