

WINDPOSTS & BRICKWORK SUPPORT SYSTEMS

The range of products span vertically between floors, and are designed to suit individual conditions on a one-off basis. The function is to allow the designer to arrive at structural solutions which are not hampered by normal considerations of slenderness ratios

with regard to brick piers and masonry panels between openings.

TECHNICAL DATA:

VEW Windposts are used to increase stiffness (and resistance to windload) of masonry panels. they consist of top and bottom connections, either plates or cleats separated by a structural section which is normally formed to increase stiffness. While head and sole connections are designed with specific applications in mind, the posts allow adjustment by the use of slotted connections for the ties. Windposts, Spandrel and Parapet Posts may be designed

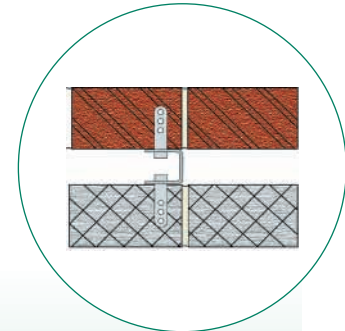

VEW1 PROPERTIES & LOADINGS

Size a x b x t	I _{zz} cm ⁴	Z _{zz} cm ³	maximum U.D.L for height of windpost (kN)							
			2.5m	3m	3.5m	4m	4.5m	5m	5.5m	6m
125x70x4	126.6	15.2	8.6	6.0	4.4	3.4	2.7	2.2	1.8	1.5
140x70x4	172.0	18.8	11.0	8.2	6.0	4.6	3.6	2.9	2.4	2.0
130x70x6	203.3	24.1	13.9	9.6	7.1	5.4	4.3	3.5	2.9	2.4
150x70x6	300.4	31.5	18.3	14.2	10.5	8.0	6.3	5.1	4.2	3.6
150x80x8	410.7	42.4	24.6	19.5	14.3	11	8.7	7.0	5.8	4.9
160x80x8	490.1	47.8	27.8	23.1	17.14	13.1	10.3	8.4	6.9	6.6

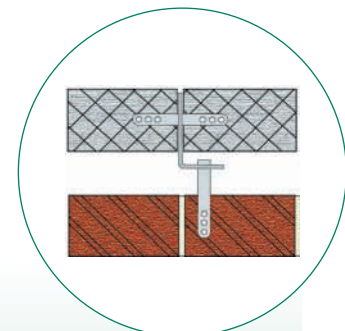

VEW2 PROPERTIES & LOADINGS

Size a x b x t	I _{zz} cm ⁴	Z _{zz} cm ³	maximum U.D.L for height of windpost (kN)							
			2.5m	3m	3.5m	4m	4.5m	5m	5.5m	6m
65x60x4	50.9	15.7	3.47	2.41	1.77	1.35	Available on request			
75x60x4	70.6	18.8	4.82	3.34	2.46	1.88	Available on request			
65x60x5	61.1	18.8	4.11	2.89	2.13	1.62	Available on request			
75x60x5	85.1	22.7	5.80	4.03	2.96	2.27	Available on request			
85x60x4	94.0	22.1	6.41	4.45	3.27	2.50	Available on request			
85x60x5	113.7	26.8	7.76	5.39	3.96	3.03	Available on request			

Windpost Site Survey Sheet

1. Windpost Type

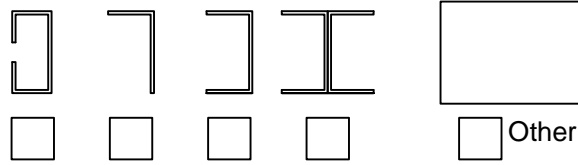

2. Section Size

3. Qty

4. Length/Height (B-T)

5. Top Connection

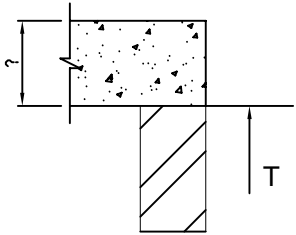

Concrete

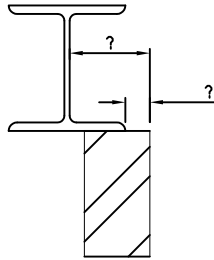

Steel

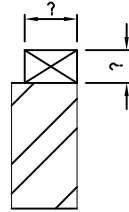

Timber Wall Plate

6. Base Connection

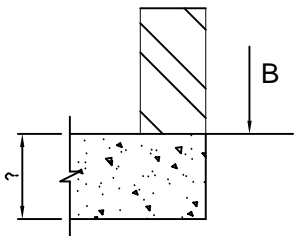

Concrete Beam

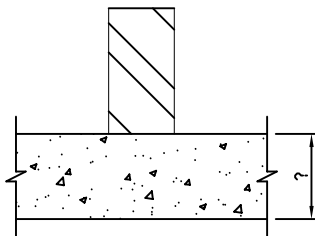

Concrete

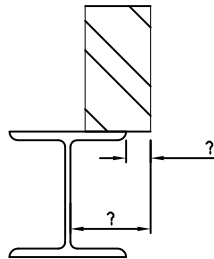

Steel

Craighead Building Supply Ltd
Block 9, Unit 1 Clydesmill Grove
Clydesmill Ind Est, Cambuslang
Glasgow G32 8NL

Tele: 0141 641 0077
Fax: 0141 641 0073

Contact:

Company:

Project:

Tel:

Fax:

Order No.

7. Block and Cavity Widths

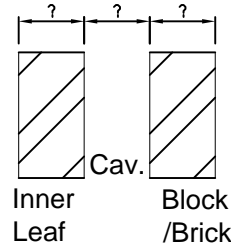

Inner Leaf _____ mm

Cavity _____ mm

Block/Brick _____ mm

8. Slot Dim.

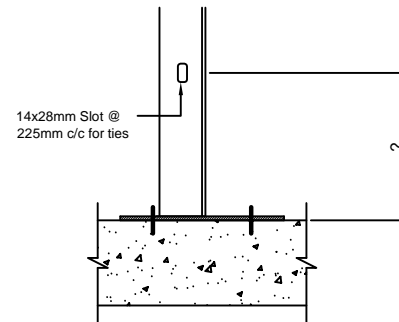

Dimension from
base plate to first
slot